

# AWM Series Monitor Arm.

## User Guide

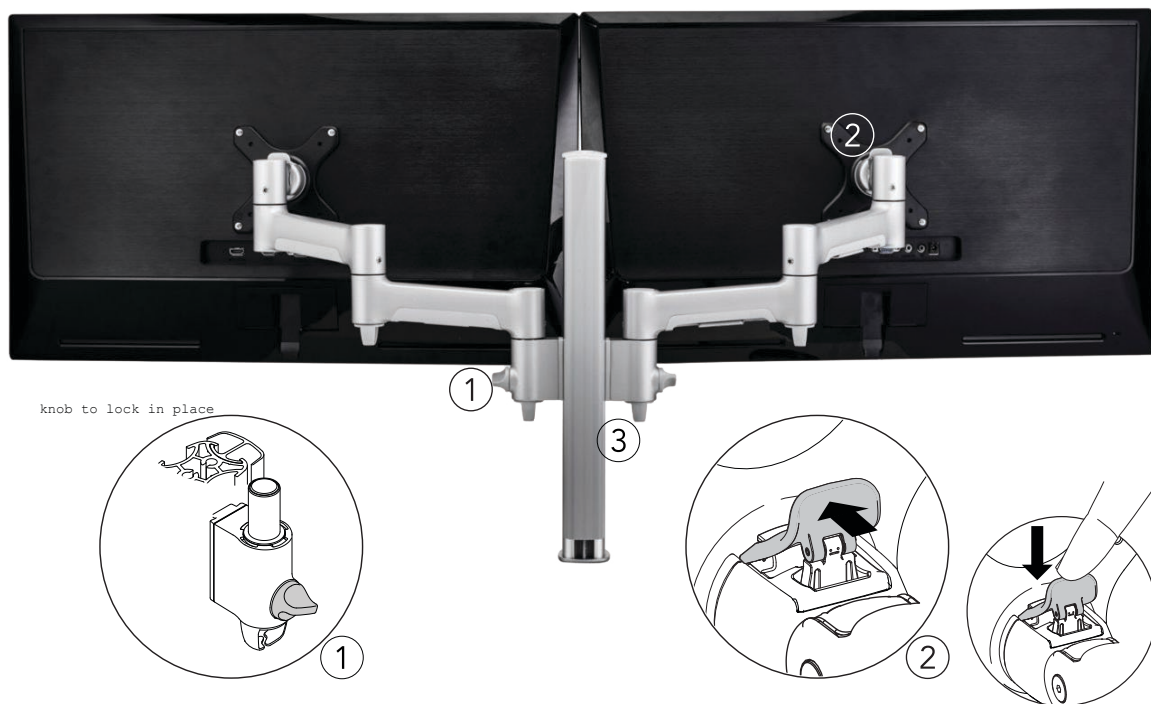

The AWM Series Monitor Arm, with its cleverly designed lever-action system allows for easy adjustment and attachment and removal of a range of modular components. Further, display height, optimal viewing angle and orientation can be set to individual requirements. Built from lightweight and yet durable aluminium, the mount can be easily recycled at the end of its life.

### 1. Arm Position

Individual monitor arms can be raised or lowered along the length of the post to suit the screen size and user.

Turn the knob on the arms counter-clockwise to loosen. Slide the arm up or down the post to the desired position, being careful to support any monitors that may be attached. Turn the knob clockwise to secure the arm in position.

### 2. VESA Release

To remove the monitor press up to raise the lever, before lifting the monitor up and off. To replace the monitor reinsert the VESA plate head, ensuring it sits flush before pushing down on the lever.

### 3. Cable Reticulation

Monitor cables can be tidied by tucking them into the cable clips and hooks located along the arms, and within the cable cover to the rear of the post.