

# Ollin Dual Bar

## Installation Guide



**AWM**

**AWM  
AMARO**

## REMOVE TILT HEAD FROM OLLIN ARM

1

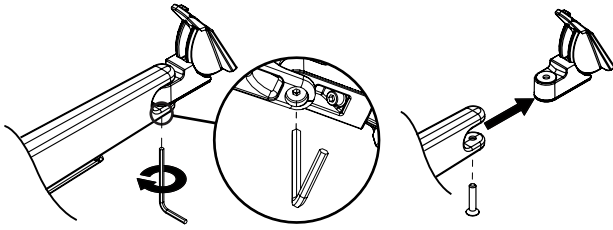

### ⚠ IMPORTANT

These parts not required for dual bar installation. You may consider retaining them in case Ollin needs to be returned to single screen configuration.

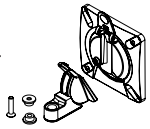

## HOW DO YOU WANT TO CONFIGURE YOUR MONITORS?

2

### Cockpit Configuration

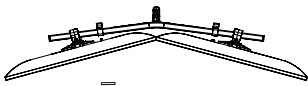

Go to step

3

### Flat Configuration

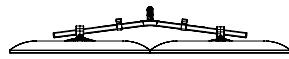

Go to step

9

## INSTALL DUAL BAR TO MONITOR ARM

3

### 3A Fit fixing bushes

Ensure that both bushes are fitted.

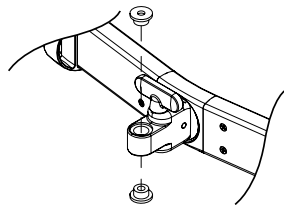

### 3B Install dual bar to arm

Ensure fixing bushes remain in place during installation.

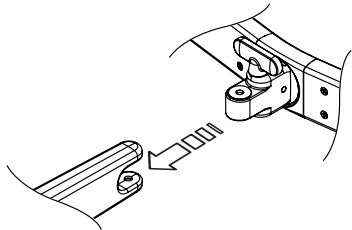

### 3C Install fixing screw

#### ⚠ IMPORTANT

Use fixing screw supplied with dual bar i.e. with red cover.

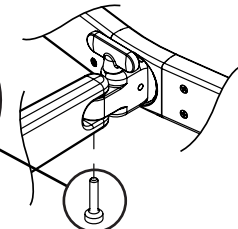
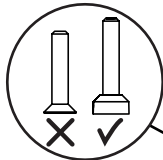

### 3D Tighten fixing screw

#### ⚠ IMPORTANT

Ensure screw is fully tightened. Red screw cover should not be visible.

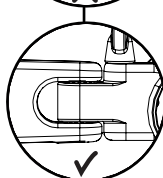
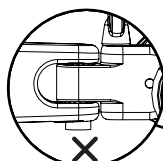

### NOTE

If using the handle (OLN/DMB/H01) this should be installed now.

## ATTACH VESA PLATES TO MONITORS

4

Repeat for second monitor.

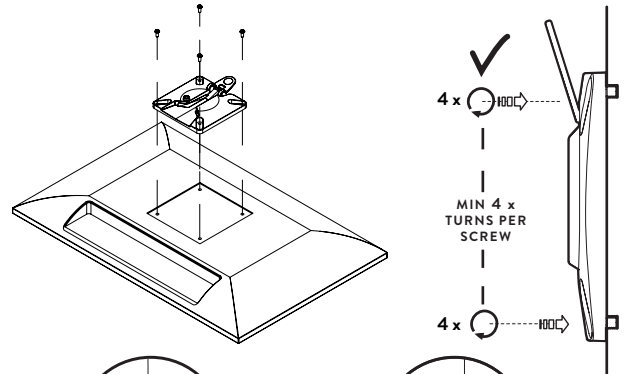

MIN 4 x TURNS PER SCREW

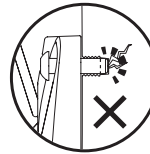

Screws over-inserted

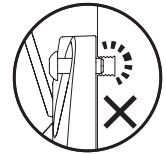

Screws under-inserted

### ⚠ IMPORTANT

It is the responsibility of the installer to ensure all mounting screws are properly engaged with a minimum of 4 x 360° turns into the display. Under or over insertion may cause damage to the equipment or injury to personnel.



i.e. Max 4kg per screen

## MOUNT MONITORS TO DUAL BAR

5

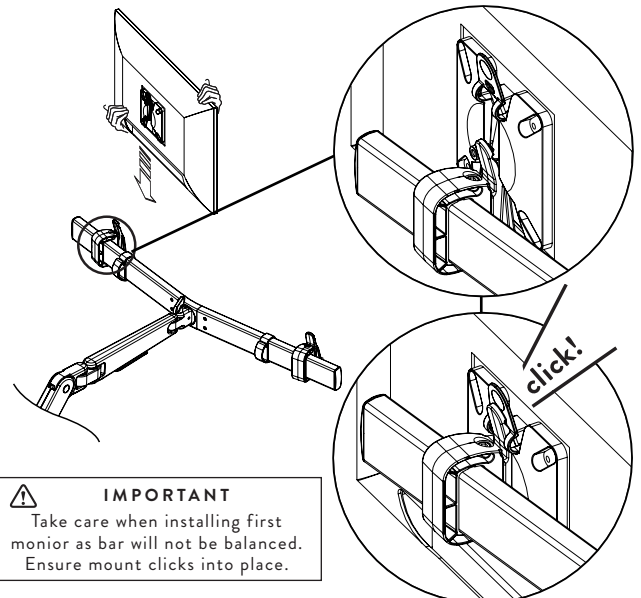

### ⚠ IMPORTANT

Take care when installing first monitor as bar will not be balanced. Ensure mount clicks into place.

**ADJUST MONITOR ARM TO SUIT WEIGHT OF MOUNTED MONITORS**

6

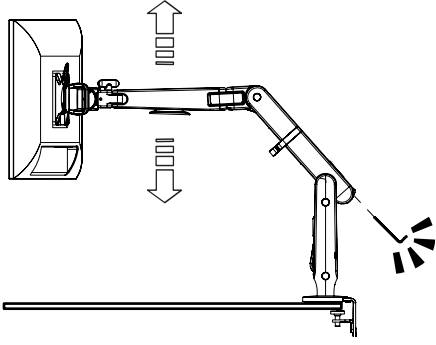

**NOTE**

See Monitor arm instructions for details of adjustment method.

**POSITION MONITORS TO SUIT VIEWING PREFERENCE**

7

**7A** Position monitors side-by-side

Simply slide monitors together on dual bar.

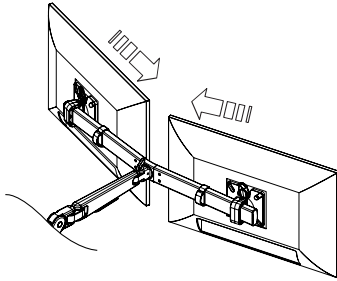

**7B** Align screens (if necessary)

- Clockwise raises monitor
- Anti-clockwise lowers monitor

Use key supplied with monitor arm

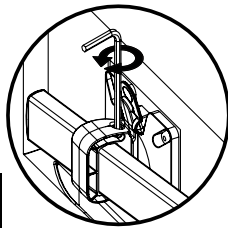
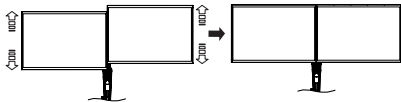

**7C** Level the screens (if necessary)

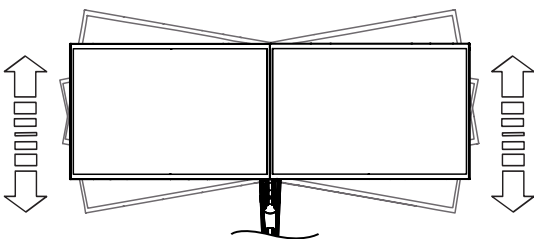

**7D** Adjust monitor tilt (if necessary)

Turn thumbscrew to tilt monitors.

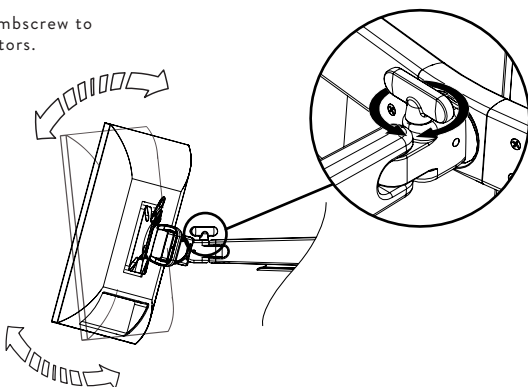

**INSTALL MONITOR CABLES INTO CABLE MANAGEMENT FEATURES**

8

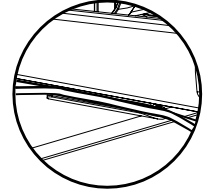
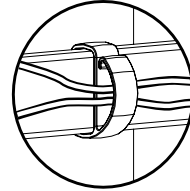
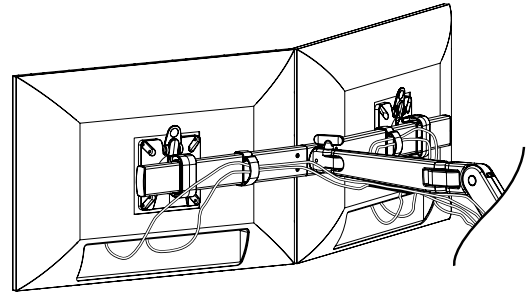

**NOTE**

See Monitor arm instructions for details on cable management.

**OPTIONAL**

**TO RECONFIGURE DUAL BAR FROM 'COCKPIT' TO 'FLAT' SCREEN FORMAT**

9

Cockpit Configuration

Flat Configuration



**9A** Using fingertip, unclip both endcaps and push them off

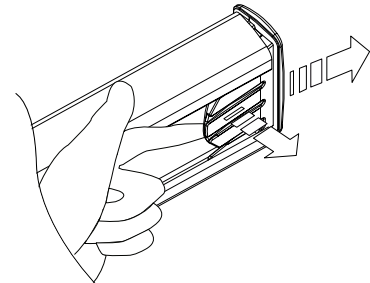

**9B** Remove both end caps

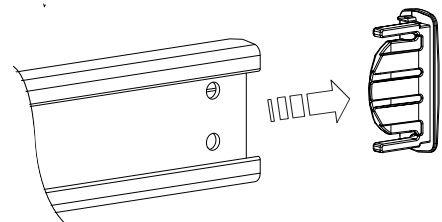

**9C** Slide mounts from dual bar

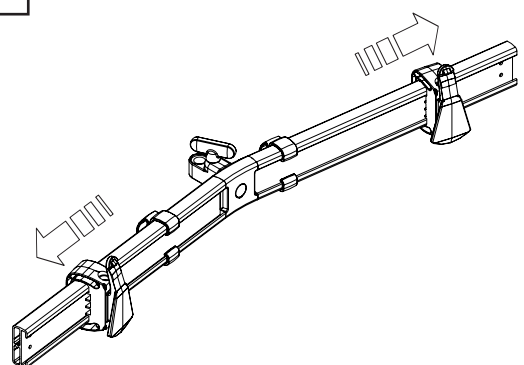

**9D** Swap mounts from one end to the other

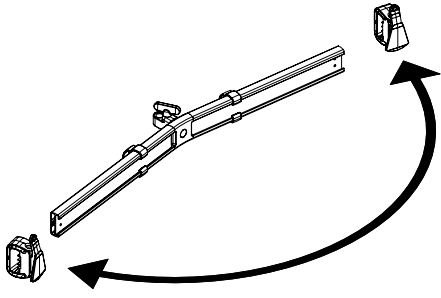

**9E** Slide mounts back onto dual bar

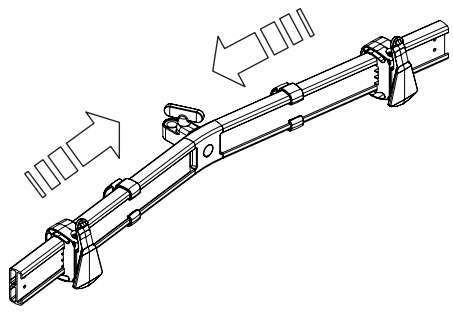

**9F** Refit end caps

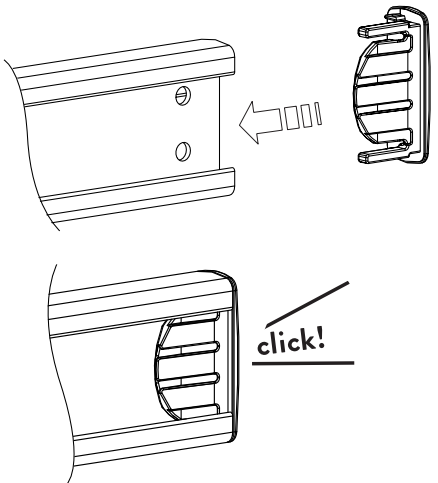

DUAL BAR IS NOW SET TO 'FLAT' CONFIGURATION

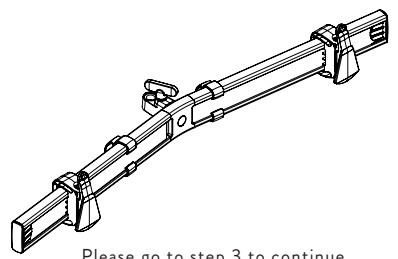

Please go to step 3 to continue installation.

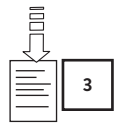

**WARNING**

- Ensure desk/work surface/wall/partition is suitable to take the weight of the arm/s and monitors.
- Do not use this product for any purpose other than that for which it was designed.
- Supported weight must not exceed 8kg (17lb) per arm.
- Hold the monitor tightly when making adjustments.
- Care should be taken to avoid trapping fingers.
  - Do not dismantle or remodel the arms.
  - Do not attach the monitor before assembling arm.
- Some monitors have recesses and may require spacers or a 75mm VESA plate.
- The screws supplied for the installation of the arm are supplied in good faith and with the intention that they will be used with the correct monitor, namely a monitor with VESA mounting holes. Please therefore check before attempting installation that you have the appropriate equipment on which to carry out the installation. CBS cannot be held liable for any damage caused to your equipment resulting from a failure to make this check. Please also carefully read the installation instructions to ensure correct fixing.

**MAINTENANCE AND INSPECTION**

- Ensure all screws are tightened and occasionally adjust if needed.
- Clean with a damp cloth, NO solvent.

**PATENT AND REGISTRATION**

- Ollin is protected by international patents and design registration.

**DISCLAIMER**

As part of Colebrook Bosson Saunders ongoing product improvement programme, the design of products may change without prior notice and details may vary from those illustrated.

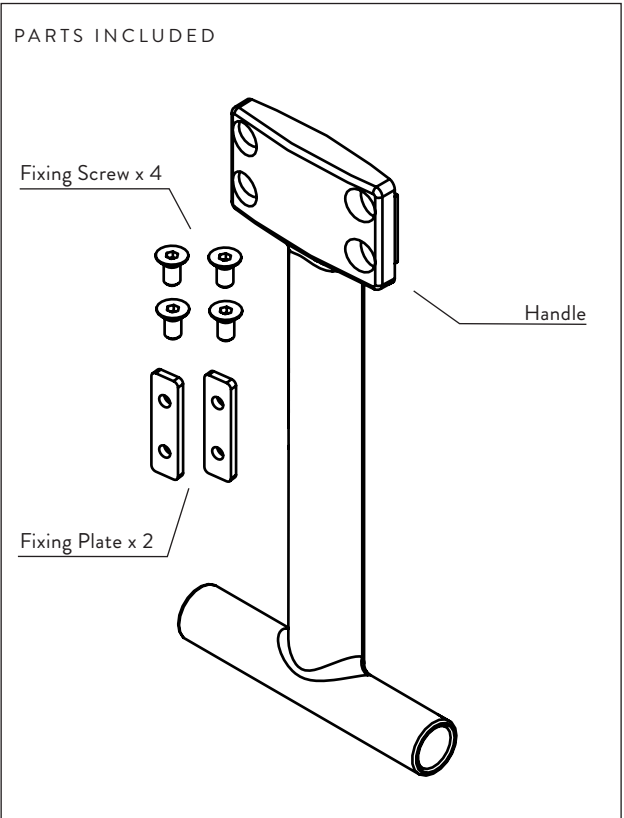
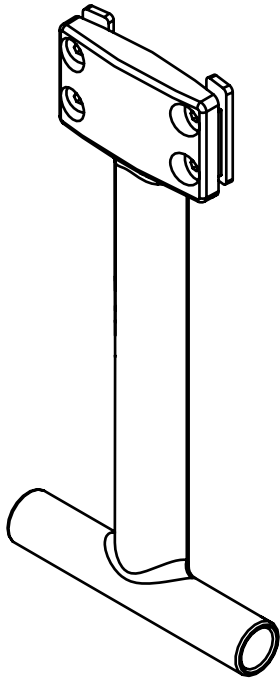

**OLLIN DUAL MOUNT BAR HANDLE**

OLN/DMB/HA1

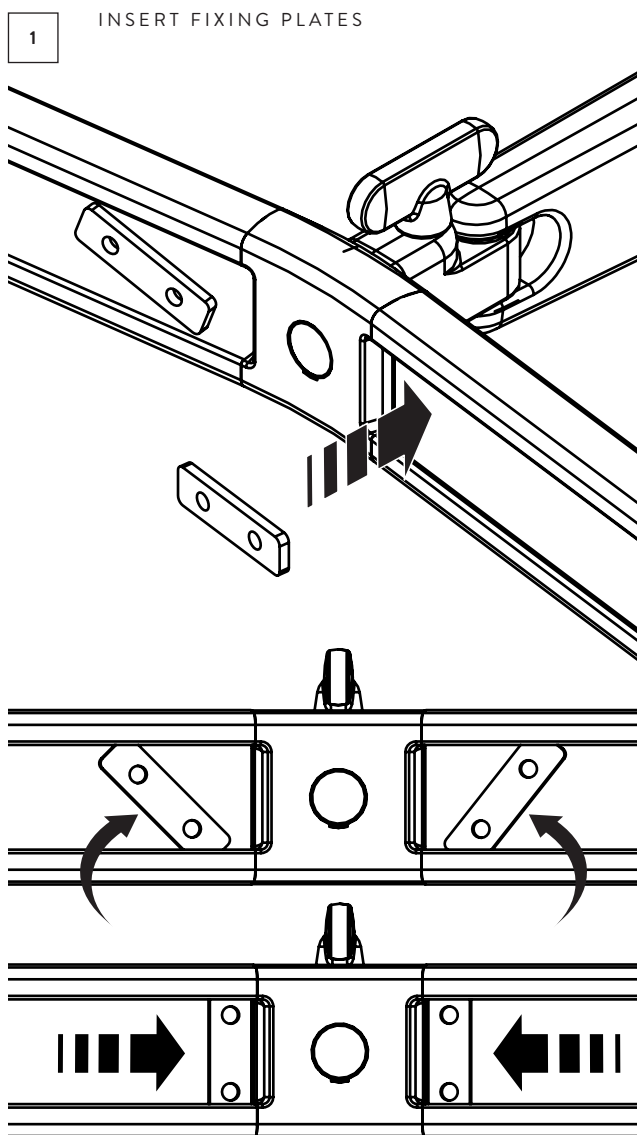

2

PLACE HANDLE IN POSITION AND SECURE ONTO DUAL BAR WITH SCREWS PROVIDED

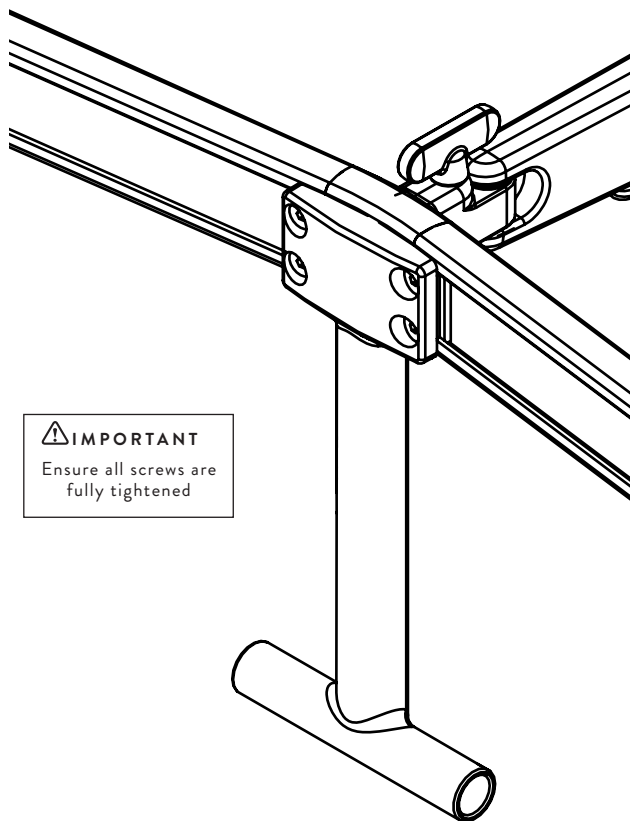
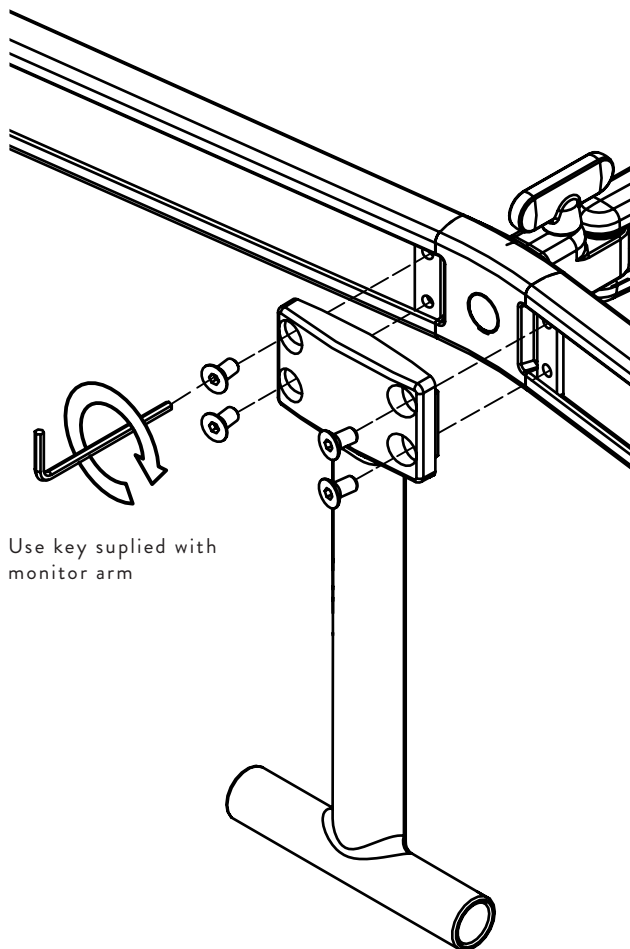

**⚠ IMPORTANT**

Ensure all screws are fully tightened

3

INSTALLATION IS COMPLETE

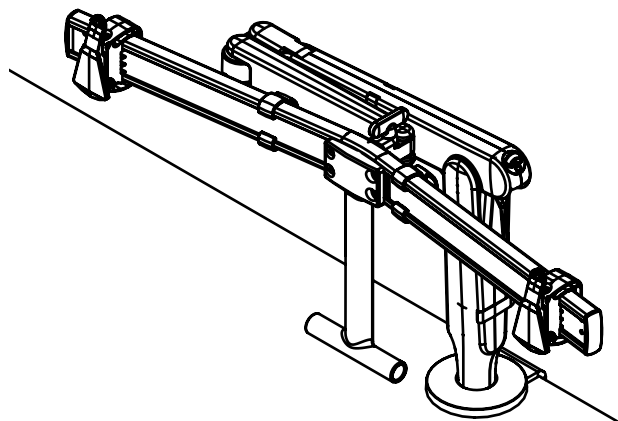

Now Dual Bar is ready for screens to be mounted

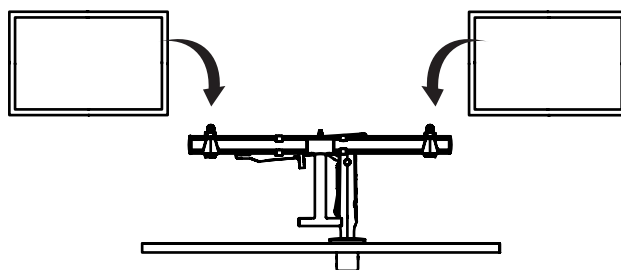

**NOTE**

Refer to arm instructions for full installation and adjustment procedure

**⚠ WARNING**

- Do not use this product for any purpose other than that for which it was designed
- Ensure desk/work surface is suitable to take the weight of the arm/s and monitors
- Supported weight must not exceed the maximum load per arm
- Take care when installing as fingers could become trapped

**⚠ MAINTENANCE AND INSPECTION**

- Ensure all screws and fixings are fully tightened and occasionally re-tighten if necessary.
- Clean with a damp cloth. DO NOT use solvents.

**⚠ DISCLAIMERS**

- The use of power tools, lever bars or excessive force during the installation, or re-configuration of the product will invalidate your guarantee
- Failure to observe the recommendations in the use, and configuration of these products may affect your guarantee
- As part of Colebrook Bosson Saunders ongoing product improvement programme, the design of products may change without prior notice and details may vary from those illustrated.

**PATENTS**

Colebrook Bosson Saunders hold a number of patents and other intellectual property rights covering our products and processes. You can find patent information on our website at: [www.colebrookbossonsaunders.com/patents](http://www.colebrookbossonsaunders.com/patents)